

Joie™

ECE R129/02

Rearward Facing:

Child height 40cm-105cm/ Child weight <19kg;

Forward Facing:

Child height 76cm-105cm/ Child weight <19kg;

i-Spin 360

enhanced child restraint

- GB Instruction Manual
- PT Manual de instruções
- ES Manual de instrucciones
- FR Mode d'emploi
- NL Handleiding

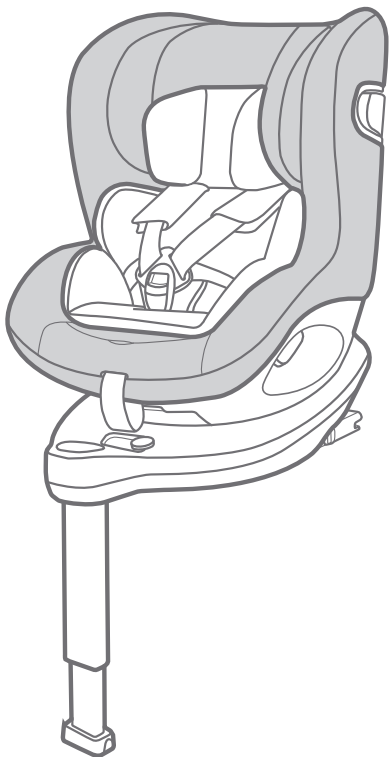

ECE R129/02: ISO/F2X, ISO/R2
ECE R129/02: i-Size

GB Welcome to Joie™

Congratulations on becoming part of the Joie family! We are so excited to be part of your journey with your little one. While traveling with the i-Spin 360 enhanced child restraint you are using a high quality, fully certified safety i-Size enhanced child restraint. Please carefully read this manual and follow each step to ensure a comfortable ride and best protection for your child.

To use this Joie enhanced child restraint with the i-Size ISOFIX connections according to the ECE R129/02 Regulation, your child must meet the following requirements.

Rearward Facing: Child height 40cm-105cm/ Child weight<19kg;

Forward Facing: Child height 76cm-105cm/ Child age at least 15 month /Child weight<19kg;

Base

Please read all the instructions in this manual before installing and using the product.

**! IMPORTANT: KEEP FOR FUTURE REFERENCE.
PLEASE READ CAREFULLY.**

Please keep the instruction manual in the storage compartment at the back of the base as right figure.

For warranty information, please visit our website at joiebaby.com



Parts List

Please make sure there are no missing parts. Please contact the retailer if anything is missing.

- Fig. 1 Head Support
- Fig. 2 Seat Pad
- Fig. 3 Buckle
- Fig. 4 Harness Adjustment Button
- Fig. 5 Adjustment Webbing
- Fig. 6 Smart Ride™ lock-off
- Fig. 7 Load Leg
- Fig. 8 Load Leg Adjustment Button
- Fig. 9 Load Leg Indicator
- Fig. 10 Recline Adjustment Button
- Fig. 11 Rotating Button
- Fig. 12 Shoulder Strap
- Fig. 13 Infant Insert
- Fig. 14 Head Support Adjustment Lever
- Fig. 15 Side Impact Shield
- Fig. 16 Instruction Manual Storage Compartment
- Fig. 17 ISOFIX Connector
- Fig. 18 ISOFIX Adjuster Button
- Fig. 19 ISOFIX Guides

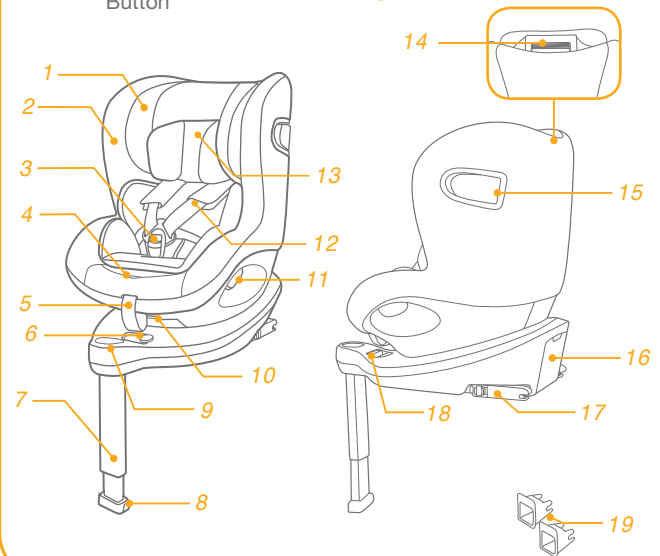

WARNING

- ! To use this enhanced child restraint with the ISOFIX connections according to the ECE R129/02 Regulation, your child must meet the following requirements.

Rearward Facing:

Child height 40cm-105cm/ Child weight \leq 19kg;

Forward Facing:

Child height 76cm-105cm/ Child age at least 15 month /Child weight \leq 19kg;

- ! **IMPORTANT - DO NOT USE FORWARD FACING BEFORE THE CHILD'S AGE EXCEEDS 15 months (Refer to instructions)**
- ! Any straps holding the enhanced child restraint to the vehicle should be tight, that any support-leg should be in contact with the vehicle floor, that any straps restraining the child should be adjusted to the child's body, and that straps should not be twisted.
- ! After your child is placed in this enhanced child restraint, the safety belt must be used correctly, and ensure that any lap strap is worn low down, so that the pelvis is firmly engaged, shall be stressed.
- ! This enhanced child restraint should be replaced when it has been subject to violent stresses in an accident. An accident can cause damage to them that you cannot see.

WARNING

- ! Concern the danger of making any alterations or additions to the device without the approval of the competent authority, and a danger of not following closely the installation instructions provided by the enhanced child restraint manufacturer.
- ! Please keep this enhanced child restraint away from sunlight, otherwise it may be too hot for child's skin. Always touch the enhanced child restraint before placing child in it.
- ! Child is not left in the enhanced child restraint system unattended.
- ! Any luggage or other objects liable to cause injuries in the event of a collision shall be properly secured.
- ! The enhanced child restraint shall not be used without the soft goods.
- ! The soft goods should not be replaced with any other than the one recommended by the manufacturer, because the soft goods constitutes an integral part of the restraint performance.
- ! **DO NOT** use any load bearing contact points other than those described in the instructions and marked on the enhanced child restraint.

WARNING

- ! NEVER install this enhanced child restraint on any vehicle seat equipped with safety airbags when used with baby mode.
- ! Please check before you purchase this enhanced child restraint to make sure it can be installed properly in your vehicle.
- ! NO enhanced child restraint can guarantee full protection from injury in an accident. However, proper use of this enhanced child restraint will reduce the risk of serious injury or death to your child.
- ! DO NOT install this enhanced child restraint without following the instructions in this manual or you may put your child at serious risk of injury or death.
- ! DO NOT use this enhanced child restraint if it has damaged or missing parts.
- ! DO NOT have your child in large/oversized clothes because this may prevent your child from being properly and securely fastened by the shoulder harness straps and the crotch strap between the legs.
- ! DO NOT leave this enhanced child restraint or other items unbelted or unsecured in your vehicle because an unsecured enhanced child restraint can be thrown around and may injure occupants in a sharp turn, sudden stop, or collision.

WARNING

- ! NEVER use a second-hand enhanced child restraint or an enhanced child restraint whose history you do not know because it may have structural damage that compromises your child's safety.
- ! NEVER use ropes or any other substitutes to secure enhanced child restraint in vehicle or to secure child into enhanced child restraint.
- ! Be sure that the enhanced child restraint is installed in such a way that no part of it interferes with movable seats or in the operation of vehicle doors.
- ! Consult the distributor for issues concerning maintenance, repair and part replacement.
- ! Remove this enhanced child restraint from the vehicle seat when it is not in use for a long period of time.
- ! The parts of this enhanced child restraint should not be lubricated in any way.
- ! Always secure child in enhanced child restraint, even on short trips, as this is when most accidents occur.
- ! Frequently check the ISOFIX guides for dirt and clean them if necessary. Reliability can be effected by ingress of dirt, dust, food particles etc.
- ! DO NOT put anything other than the recommended inner cushions in this enhanced child restraint.
- ! The child restraint may not fit in all approved vehicles when used in one of these positions.

Emergency

In case of emergency or accidents, it is most important to have your child taken care of with first aid and medical treatment immediately.

Product Information

"i-Size" (Integral Universal ISOFIX Enhanced Child Restraint Systems) is a category of Enhanced Child Restraint System for use in all i-Size seating position of a vehicle.

1. According to the ECE R129/02 Regulation, the product is a Universal ISOFIX Class ISO/F2X, ISO/R2 enhanced child restraint and should be fitted using the ISOFIX connections.
2. This is an "i-Size" Enhanced Child Restraint System. It is approved according to Regulation No.129, for use in, i-Size compatible vehicle seating positions as indicated by vehicle manufacturers in the vehicle users' manual.
3. If in doubt, consult either the Enhanced Child Restraint System manufacturer or the retailer.

Materials Plastics, metal, fabrics



Patent No. Patents pending

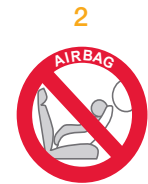
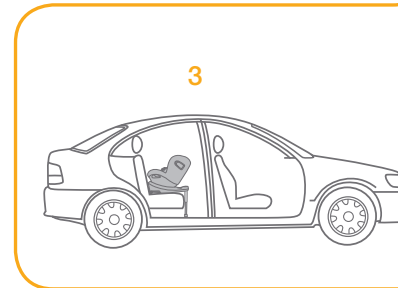
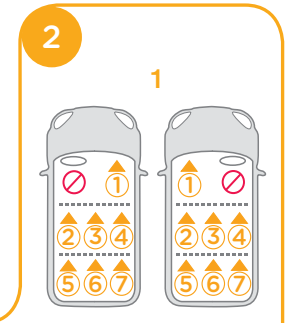
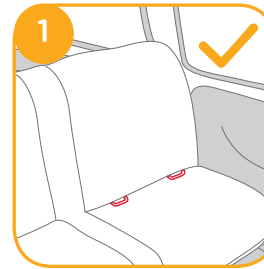

Concerns on Installation

see images 1 - 2

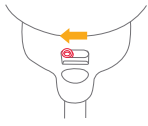

Choose the Installation Mode

	Child's Size	Installation Mode	Installation	Reference Age	Recline Position
ECE R129/02	40cm-105cm/ ≤19kg	Rear facing mode		Approx 4 years	Position 1-6
	76cm-105cm/ ≤19kg	Forward facing mode		15 months to approx 4 years	Position 1-6

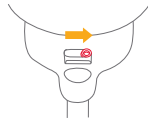
Child's Age	Installation Mode	Installation	Smart Ride™ lock-off
0-15M	Rear facing mode		
> 15M	Rear/ Forward facing mode	 or 	

Installing the Base

see images 3 - 12

! After placing the base on the vehicle seat, pull the load leg downward to floor. 3

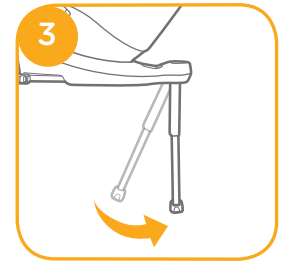

! Insert ISOFIX guides to assist with installation. 4 -1

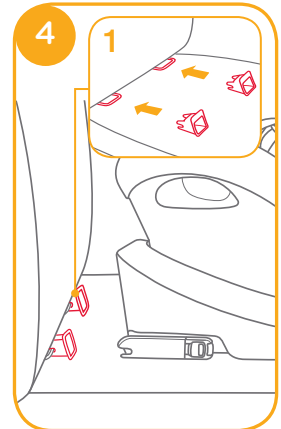

! There are 11 adjustable positions for ISOFIX. Whilst depressing the ISOFIX button 5-1, pull out the ISOFIX connector. 5-2

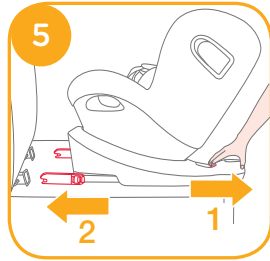

! Make sure that both ISOFIX connectors are securely attached to their ISOFIX anchor points. The colors of the indicators on both ISOFIX connectors should be completely green. 6-1

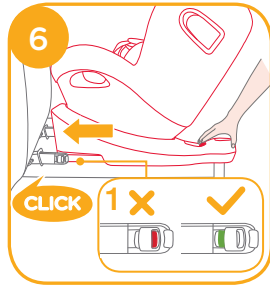

! After successfully installing the ISOFIX connectors, press the ISOFIX adjustment buttons again while pushing the seat back until it comes in contact with the vehicle seat back. 6

! After attaching the ISOFIX, pull the load leg downward to floor. When the load leg indicator shows green, the load leg is installed correctly.

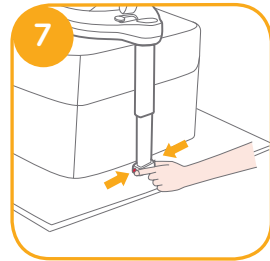

! Squeeze the load leg releasing button, then adjust the load leg length. 7

! The load leg has 19 positions. When the load leg indicator shows red this means the load leg is in the wrong position. 8

! Make sure the load leg is in full contact with the vehicle floor pan. Red means it is installed incorrectly. 8

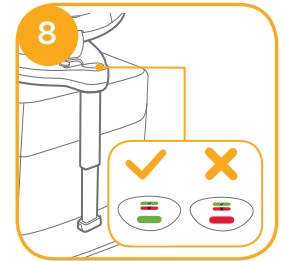

! Check to make sure the base is securely installed by pulling on both ISOFIX connectors.

! The ISOFIX connectors must be attached and locked onto the ISOFIX anchor points. 9-1

! The load leg must be installed correctly with green indicator. 9-2

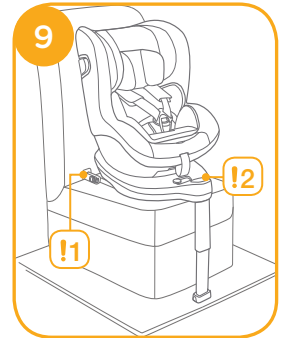

Removing the base

To remove from the vehicle press the ISOFIX adjuster button **10 -1** and pull the base back from the seat. **10 -2**

Then press and release the connectors from the vehicle's ISOFIX. **11**

To prevent damage during transit, press the ISOFIX adjuster button **12 -1** and fold the connector completely. **12 -2**

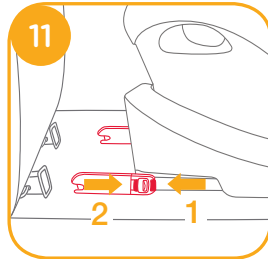
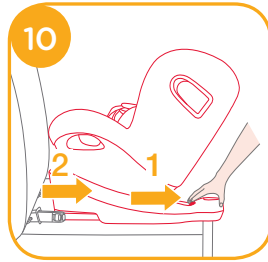

Use Side Impact Shield

see images **13 - 15**

! Ensure the side impact protection shield is locked in the open position for maximum side impact safety.

1. Side impact shields are automatically activated when the harness buckle is moved back into position and the harness is tightened, both sides will be opened automatically. **13 -1** **13 -2**

! IMPORTANT: Please note that unfolding the side impact protection elements does NOT mean that the child is already restrained tight enough.

2. The side impact shield opposite the vehicle door can be closed to allow more seating space, if needed. The side closest to the vehicle exterior should always be in the open position. **14 -1** **14 -2**

3. The side impact can be manually opened as shown on **15**.

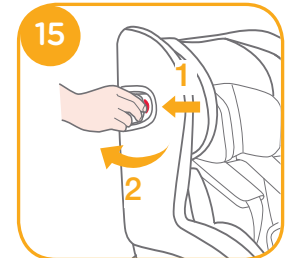
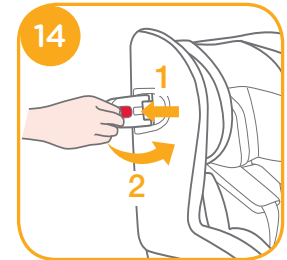
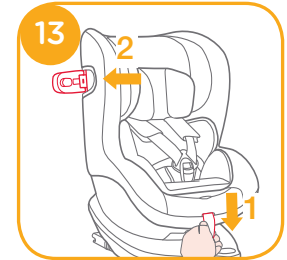

Recline Adjustment

see images 16 - 17

Squeeze the recline adjustment button 16, to adjust the enhanced child restraint to the proper position. The recline angles are shown as 17

Please recheck the load leg position after reclining.

There are 6 recline positions for rear facing mode and 6 recline positions for forward facing mode.

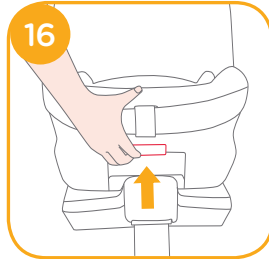

Height Adjustment

for Head Support and Shoulder Harnesses

see images 18 - 20

1. Please adjust the head support and check if the shoulder harnesses are at the correct height according to 18

! When used rear facing, the shoulder harness height must be even with or below the top of child's shoulders. 18

! When used forward facing, the shoulder harness height must be even with the top of child's shoulders. 18

2. Squeeze the head support adjustment lever 19, meanwhile pull up or push down on the head support until it snaps into one of the 6 positions. The head support positions are shown as 20.

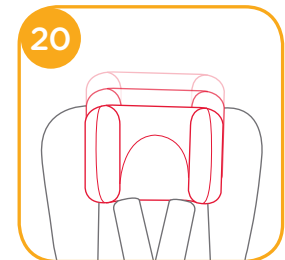
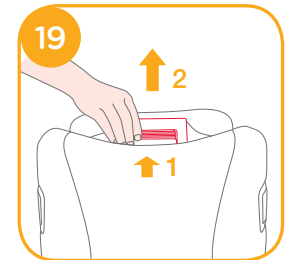

Using in the Rear Facing Mode

(Child height 40cm-105cm/Child weight ≤ 19kg/infant - 4 years old)

see images 21 - 32

! Please install the enhanced child restraint on the rear vehicle seat, and then put the child in the enhanced child restraint.

! Please slide Smart Ride™ lock-off to left when enhanced child restraint used in rearward facing mode.

1. Press the ISOFIX adjuster button 22 -1 and pull the base back from the vehicle seat.

2. Press the rotating button to rotate for easier side loading/unloading of the child, then rotate the seat to the rear facing position. 23 & 24

! Press the rotating button on either side to rotate the enhanced child restraint.

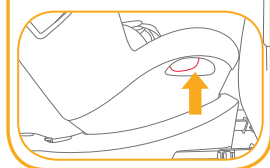
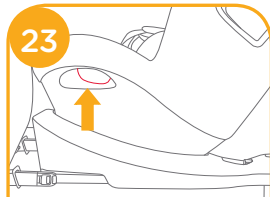
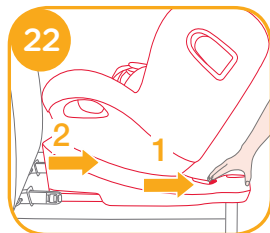
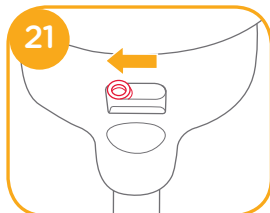

3. After successfully installing the ISOFIX connectors, press the ISOFIX adjustment buttons again while pushing the seat back until it comes in contact with the vehicle seat back. 25 -1 25 -2

! The ISOFIX connectors must be attached and locked onto the ISOFIX anchor points. 26 -1

! The load leg must be installed correctly with green indicator. 26 -2

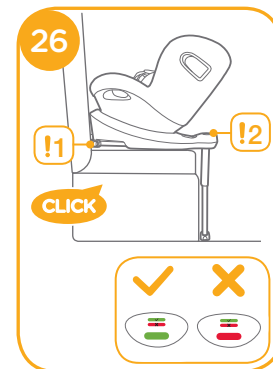

Securing Child

1. Press the webbing adjustment button, while pulling out the shoulder harnesses to the desired length. (Pull from below the fixed shoulder pads to lengthen) length. **27**

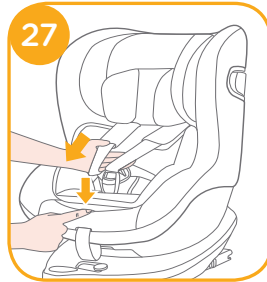

2. Unlock the buckle of the harnesses by pressing the red button. **28**

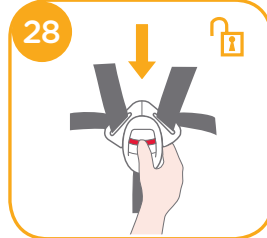

3. Fix the buckles on the both sides of the seat shown as **29** which located on the both sides of seat to make placing the child in rear facing mode more convenient.



4. Please make sure the infant insert has the wedge assembled before using it for infant. **30**

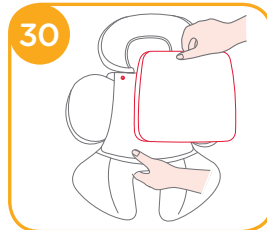

<p>Detach the snaps on the head support to remove the head portion of the insert.</p>	<p>Remove the head support portion of the infant insert when the infant's head no longer fits comfortably.</p>
	<p>Remove the body portion of the infant insert when the infant's shoulders no longer fit comfortably.</p>
<p>We recommend using the full infant insert while the baby is under 60cm and can be used until they outgrow the insert. The infant insert increases side impact protection.</p>	<p>1 Remove the infant insert cushion by detaching the snaps to allow more space when the infant does not fit comfortably. The cushion can be used separately without being attached to the insert to bolster the infant's back for more comfort.</p>
	<p>2</p>

5. Place the child into the enhanced child restraint and pass both arms through the harnesses.

! After the child is seated, recheck whether the shoulder harnesses are at the proper height.

6. Engage the buckle. Please refer to **31**

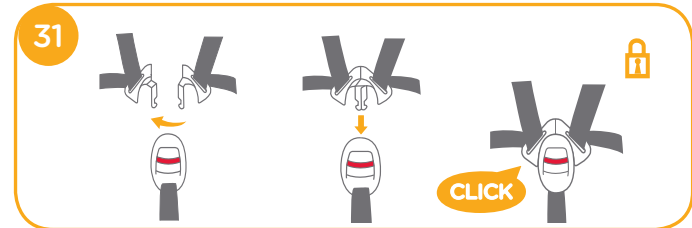

7. Pull down the adjustment webbing and adjust it to the proper length to make sure your child is properly secured. 32

! Always keep child secured in harness and properly tightened by removing any slack.



Using in the Forward Facing Mode (Child height 76cm-105cm/Child weight ≤19kg/15 months - 4 years old)

see images 33 - 41

! Please install the enhanced child restraint on the vehicle seat, and then put the child in the enhanced child restraint.

! Please slide Smart Ride™ lock-off to right when enhanced child restraint used in forward facing mode. 33

1. Press the ISOFIX adjuster button 34 -1 and pull the base back from the vehicle seat. 34 -2

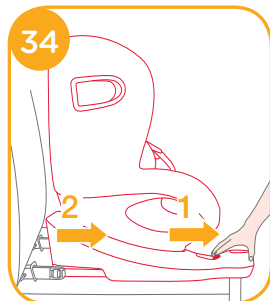
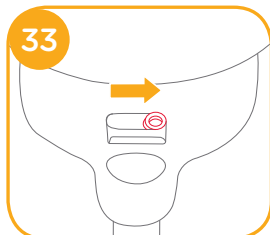

2. Press the rotating button to rotate for easier side loading/unloading of the child, then rotate the seat to the forward facing position. 35& 36

! Press the rotating button on either side to rotate the enhanced child restraint.

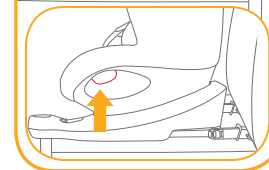
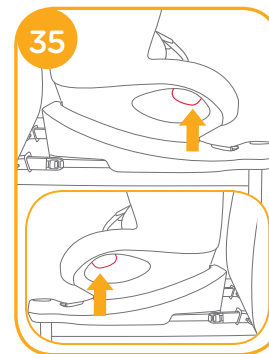

3. After successfully installing the ISOFIX connectors, press the ISOFIX adjustment buttons again while pushing the seat back until it comes in contact with the vehicle seat back. 37 -1 37 -2

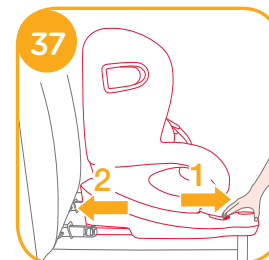

! The ISOFIX connectors must be attached and locked onto the ISOFIX anchor points. 38 -1

! The load leg must be installed correctly with green indicator. 38 -2

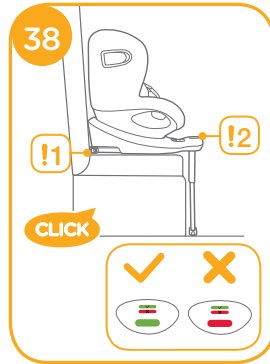

Securing Child

1. Press the webbing adjustment button, while pulling out the shoulder harnesses to the desired (Pull from below the fixed shoulder pads to lengthen) length. 39



2. Unlock the buckle of the harnesses by pressing the red button. 40

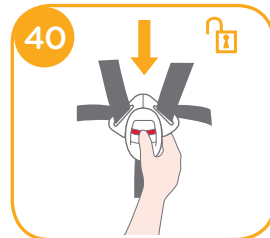

3. Fix the buckles on the both sides of the seat shown as 41 which located on the both sides of seat to make placing the child in forward facing mode more convenient.

4. When installing the enhanced child restraint in the forward facing mode, do not use the infant insert.

5. Place the child into the enhanced child restraint and pass both arms through the harnesses. Engage the buckle.

! After the child is seated, recheck whether the shoulder harnesses are at the proper height.

6. Pull down the adjustment webbing and adjust it to the proper length to make sure your child is properly secured. 42

! Always keep child secured in harness and properly tightened by removing any slack.

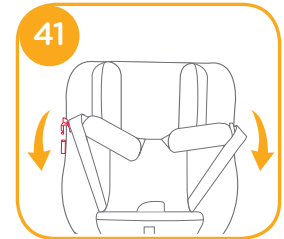

Detach Soft Goods

see images 43 - 49

Press the red button to disengage the buckle. 43

Follow steps 44 - 49 to detach soft goods.

To re-attach the soft goods please repeat the above steps in the reverse step.

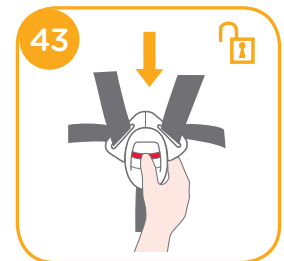

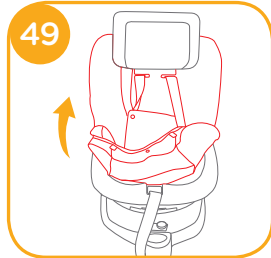
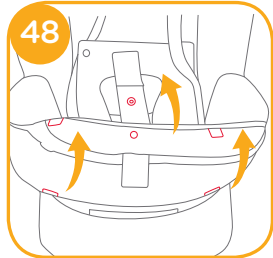
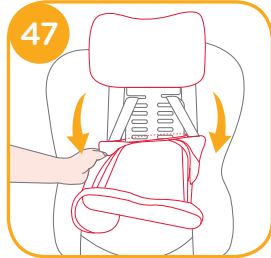
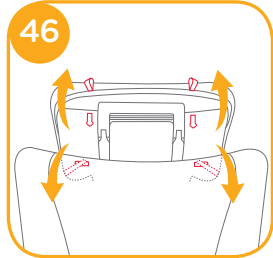
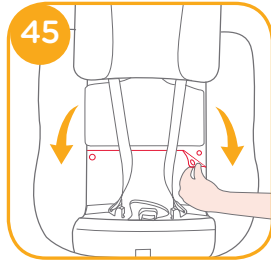
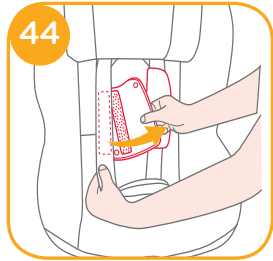

Care and Maintenance

- ! After removing the wedge from the insert, please store it somewhere that the child cannot access it.
- ! Please wash the seat cover and inner padding with cold water under 30°C.
- ! Do not iron the soft goods.
- ! Do not bleach or dry clean the soft goods.
- ! Do not use undiluted detergents, gasoline or other organic solvent to wash the enhanced child restraint or base. It may cause damage to the enhanced child restraint.
- ! Do not wring out the seat cover and inner padding to dry. It may leave the seat cover and inner padding with wrinkles.
- ! Please hang dry the seat cover and inner padding in the shade.
- ! Please remove the enhanced child restraint and base from the vehicle seat if not in use for a long period of time. Put the enhanced child restraint in a cool, dry place where your child cannot access it.
- ! Do not tamper with the harness connectors during cleaning.

